

11. Sew (4) **CHAIN BLOCKS** together end to end. *Make 2.* Sew to each side of the quilt.

12. Sew (1) **D** 1 ½" x 7 ½" rectangle to the right side of (1) **A** 7 ½" square. Sew (1) **D** 1 ½" x 8 ½" rectangle to the top of the block. Make 4 **LARGE CORNERSTONE BLOCKS**. Square to 8 ½". Set aside.

LARGE CORNERSTONE BLOCKS

12.



13. Sew (3) **CHAIN BLOCKS** together end to end. Sew a **LARGE CORNERSTONE BLOCK** to each end of the Chain block row, making sure the Cornerstone Blocks are rotated with the Fabric **D** strips to the inside as shown. *Make 2.*

QUILT DIAGRAM

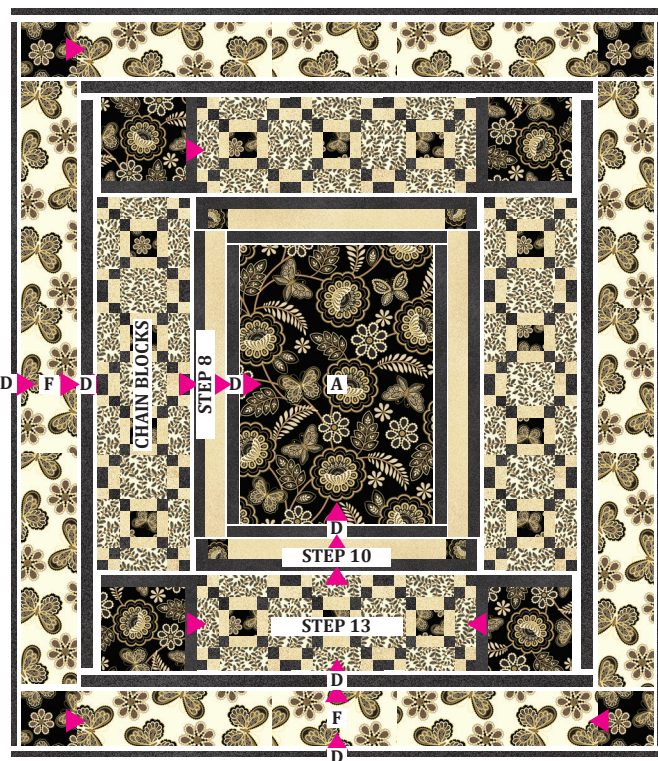

Sew to the top of the quilt, rotate the second row and sew to the bottom of the quilt.

14. **D BORDER** - Sew (1) **D** 1 1/2" x (48 1/2") border strip to each side of quilt. Sew (1) **D** 1 1/2" x (42 1/2") border strip to the top and bottom of quilt.

15. **F BORDER** - Sew (1) **F** 5 ½" x (50 ½") strip to each side of the quilt. Sew (1) **B** 5 ½" square to each end of (1) **F** 5 ½" x 42 ½" strip. *Make 2.* Sew to the top and bottom of the quilt.

Layer quilt, quilt as desired and bind using the **D** 2 ½" strips.

FINISHING : Cut batting and backing 3" larger than top on all sides. Layer backing, batting and top together and baste or pin. When quilting is completed, trim excess batting and backing. Bind as usual.

Finished Quilt Size: 52" W x 60"L

Note: If this Benartex pattern is included in a kit, any questions about the kit should be addressed to the vendor from whom you bought it.

Wings of Gold

DESIGN BY DIANE NAGLE



© 2014 Diane Nagle for Benartex, LLC

Elegant and sophisticated, this "Wings of Gold" quilt is well named. The beautiful flowers, leaves, and butterflies are lightly touched with metallic gold. Exquisite!

Uses Benartex's Metallic Lace collection
by Dover Hill
Finished Size: 52" x 60"

Benartex

Fabric for quilters.
By quilters.

SAMPLE	KEY/SKU	QTY	CUT
A	Metallic Lace 5112M-12 Black	1 YD	(1) 16 1/2" x WOF strip, sub cut (1) 16 1/2" x 24 1/2" center rectangle. (1) 7 1/2" x WOF strip, sub cut (4) 7 1/2" squares.
B	Butterflies and Flowers 5119M-12 Black/Gold	1/4 YDS	(1) 2 1/2" x WOF strip, sub cut (14) 2 1/2" squares. (1) 5 1/2" x WOF strip, sub cut (4) 5 1/2" squares. Trim remaining strip down to 2 1/2" wide and sub cut (4) 2 1/2" squares.
C	Metallic Leaf Scroll 5115M-07 Ivory/Gold	1/2 YD	(7) 2 1/2" x WOF strips, sub cut (56) 2 1/2" x 4 1/2" rectangles.
D	Blush 2045-11 Black	1-3/8 YD	(6) 1 1/2" x WOF strips, sub cut (168) 1 1/2" squares (3) 1 1/2" x WOF strips, sub cut (4) 1 1/2" x 2 1/2" strips (4) 1 1/2" x 3 1/2" strips (4) 1 1/2" x 7 1/2" strips (4) 1 1/2" x 8 1/2" strips (9) 1 1/2" x WOF strips; sew end to end and sub cut (2) 1 1/2" x 24 1/2" strips (4) 1 1/2" x 18 1/2" strips (2) 1 1/2" x 26 1/2" strips (2) 1 1/2" x 48 1/2" strips (2) 1 1/2" x 42 1/2" strips (6) 2 1/2" x WOF strips*; binding
E	Blush 2045-70 Vanilla	5/8 YD	(4) 1 1/2" x WOF strips, sub cut (112) 1 1/2" squares. (2) 2 1/2" x WOF strips, sub cut (56) 1 1/2" x 2 1/2" rectangles (2) 2 1/2" x 18 1/2" strips (2) 2 1/2" x 26 1/2" strips
F	Butterflies and Flowers 5119-07 Ivory/Gold	1 YD	(5) 5 1/2" x WOF strips*; outer border
G	Metallic Leaf Scroll 5115M-07 Ivory/Gold	3-3/8 YD	backing

*SEW STRIPS VIA SHORT ENDS, THEN SUBCUT AS INDICATED | WOF= WIDTH OF FABRIC

CHAIN BLOCK ASSEMBLY:

1. Sew (1) E 1 1/2" x 2 1/2" rectangle to each side of (1) B 2 1/2" square to make Unit 1.



2. Sew (1) D 1 1/2" square to each short end of (1) E 1 1/2" x 2 1/2" rectangle.

Make 2.

3. Sew (1) Unit 2 to the top and bottom of Unit 1 to complete block center. Square to 4 1/2".

4. Sew (1) D and E 1 1/2" square together on the sides. Make 2. Rotate one of these and sew (2) D/E units together to make a 4-patch unit. Square to 2 1/2".

Make 4. Set aside.

5. Sew (1) C 2 1/2" x 4 1/2" rectangle to each side of the block center.

6. Sew (1) 4-patch unit to each short end of (1) C 2 1/2" x 4 1/2" rectangle. *Make 2.* Sew to the top and bottom of the block to complete. **Repeat steps 1-6 to make (14) Chain blocks.** Square to 8 1/2". Set aside.

QUILT ASSEMBLY:

7. Sew (1) D 1 1/2" x 24 1/2" strip to each side of the A 16 1/2" x 24 1/2" center panel. Sew (1) D 1 1/2" x 18 1/2" strip to the top and bottom of the panel center.

8. Sew together the long sides of (1) E 2 1/2" X 26 1/2" and (1) D 1 1/2" x 26 1/2" rectangle. Make 2. Sew (1) to each side of the quilt center, with the D strip to the outside.

9. Sew (1) D 1 1/2" x 2 1/2" rectangle to one side of (1) B 2 1/2" square. Sew (1) D 1 1/2" x 3 1/2" rectangle to the top of the unit. Square to 3 1/2". **Repeat to make 4 Corner Units.** Set aside.

10. As in step 8, sew together the long sides of (1) E 2 1/2" x 18 1/2" and (1) D 1 1/2" x 18 1/2" rectangle. *Make 2.* Sew (1) corner unit from step 9 to each end of the pieced border unit, making sure the corner unit is rotated to match the Fabric D strip with the side borders. *Make 2.* Sew to the top and bottom of the quilt.

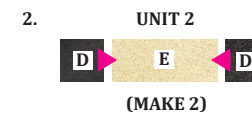

(MAKE 2)

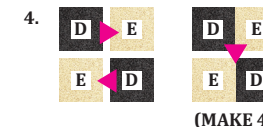
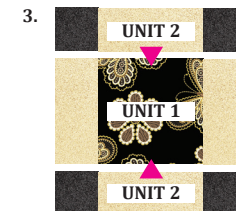

(MAKE 4)

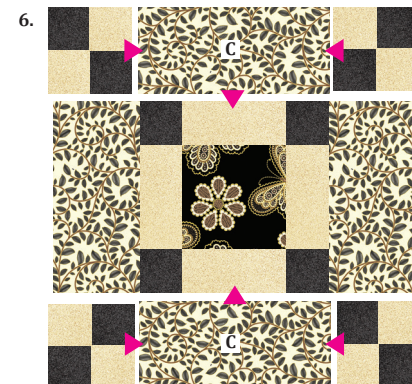
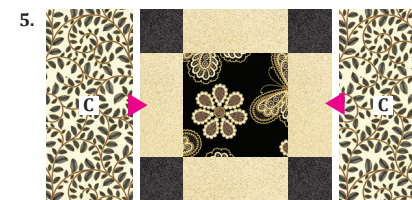

9. CORNER UNIT



(MAKE 4)